

Duplex for Rent

Please call for current rates
(Unit Address: 3110-3180 NE Cleveland)

Contact: Doug and Kathy Moore
(503) 661-2858 (or Doug's Cell Phone at 503-504-6824)
Best time to call: 1-7:00pm

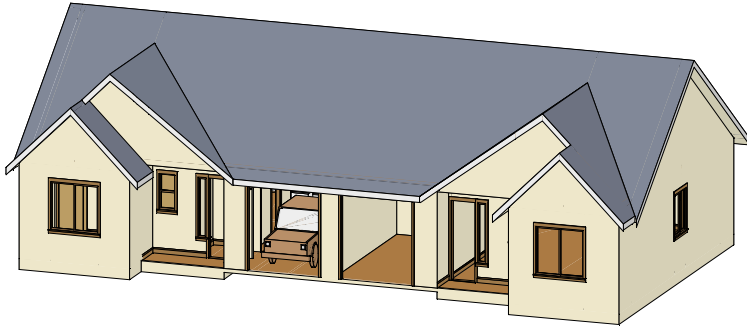

Amenities Include:
2 Bedrooms and 2 Baths
Spacious Living Room
Fenced in Yard
Washer/Dryer Connections in Garage
Extensive Storage Areas
Water/Sewer Service Included
Garbage is Included
1095 Square Feet
Single Bay Garage

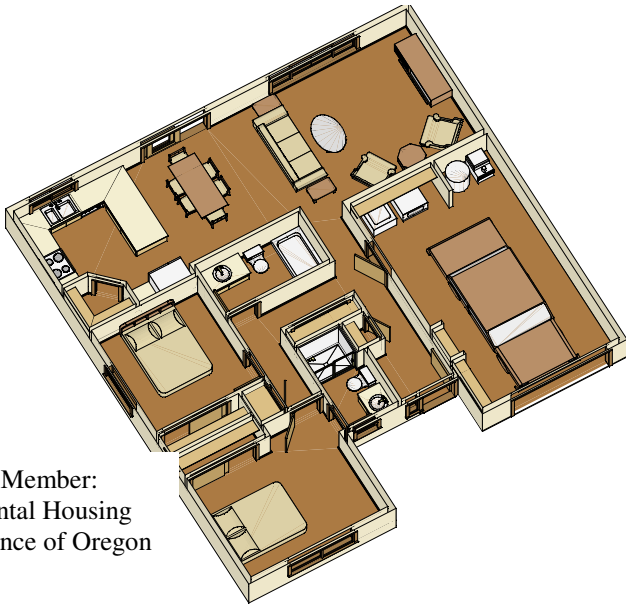

Member:
Rental Housing
Alliance of Oregon

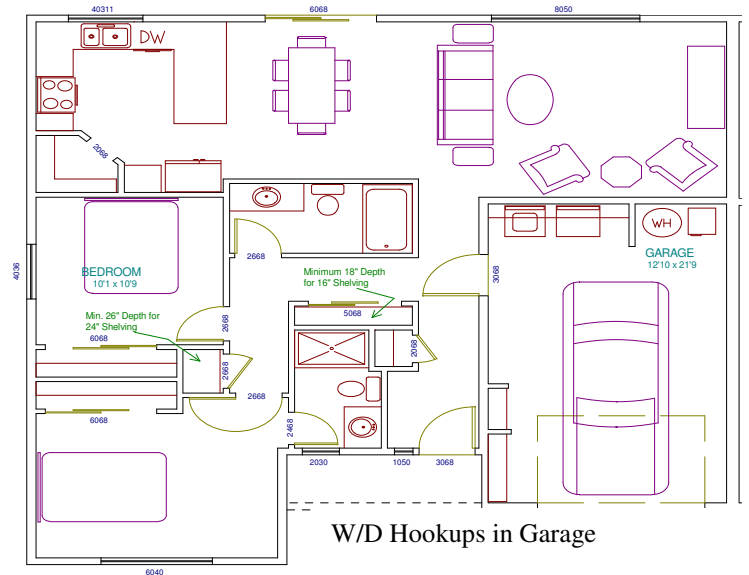

This is a 2 bedroom/2 bath duplex completed in October, 1997! Conveniently located very near bus service, a convenience store, and an athletic club. Required are a security deposit of \$750 and prorated rent to move in. The rent is due on the 1st of the month and is late on the 5th. We allow small pets for an additional \$250 deposit each. There is also a \$35 per adult Applicant Fee and is returned if your application is rejected. If you want more information about these units, please give us a call: 503-504-6824. **We have other duplexes in the Gresham/Troutdale area at various rental rates from \$1100 – please feel free to ask if we have others currently available or get on our waiting list which we work through first.**